

# TRANSFORMERS

## 1Ø EN(CE) Certified Transformers (단상 CE인증 트랜스)

CE TUV

### BHTB-DM TU Series



#### Technical Specifications

Primary Voltage	200_R208_220_230V
Secondary Voltage	208_R220_230V
Operating Frequency	50/60Hz
Insulation Class	H Class
Standard	EN61558-2-4

#### Typical Applications

- Control panel
- Semi conductor, Display power equipment
- Machinery
- Heater control
- etc.

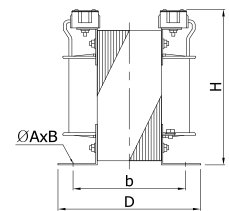
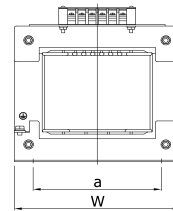
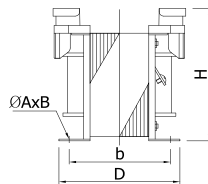
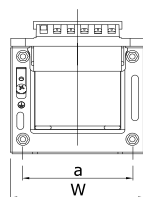
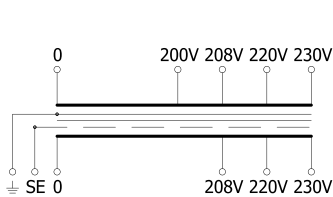
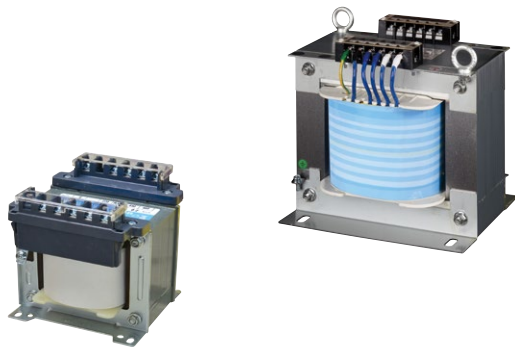

Fig.1

Fig.2

TO THE WORLD BUMHAN • WE MAKE FOR YOU • TO THE WORLD BUMHAN • WE MAKE FOR YOPU • TO THE WORLD BUMHAN • WE MAKE FOR YOU • TO THE WORLD BUMHAN

#### Selection Table

Type (형식명)	Specification(사양)			Dimension (외형치수, mm)						Weight (kg)	Remark	Shape
	Pri.(V)	Sec.(V)	Cap.(VA)	W	D	H	a	b	ØA×B			
BHTB -DM50TU	230V 220V 208V 200V 0	230V 220V 208V 0 SE	50	79	98	87	65	77	5×8	1.7	Fig. 1	
-DM100TU			100	90	101	95	72	77		2.3		
-DM200TU			200	110	115	116	94	87		3.7		
-DM300TU			300	138	124	139	110	89	5×10	6.5		
-DM500TU			500	156	158	155	130	104	6×10	10.2		
-DM1KTU			1k	185	153	178	160	122	8×20	15.5		
-DM2KTU			2k	220	179	218	170	139	10×25	24.8		Eye Bolts
-DM3KTU			3k	258	206	245	195	156		37.6		
-DM5KTU			5k	280	218	269	220	174		53		
-DM10KTU			10k	311	290	306	252	240		13×30		

TO THE WORLD BUMHAN • WE MAKE FOR YOU • TO THE WORLD BUMHAN • WE MAKE FOR YOU • TO THE WORLD BUMHAN • WE MAKE FOR YOU • TO THE WORLD BUMHAN