

TRANSFORMERS

1Ø EN(CE) Certified Transformers (단상 CE인증 트랜스)

CE TUV

BHTB-DQ TU Series



■ Technical Specifications

Primary Voltage	R380_400_415_440V
Secondary Voltage	110_R220_230V
Operating Frequency	50/60Hz
Insulation Class	H Class
Standard	EN61558-2-4

■ Typical Applications

Control panel
Semi conductor, Display power equipment
Machinery
Heater control
etc.

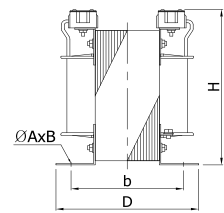
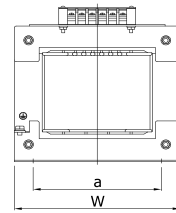
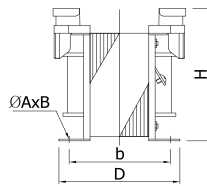
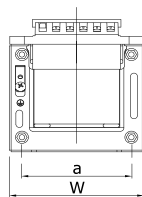
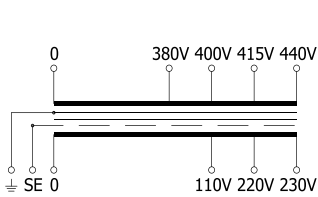

Fig.1

Fig.2

TO THE WORLD BUMHAN ● WE MAKE FOR YOU ● TO THE WORLD BUMHAN ● WE MAKE FOR YOU ● TO THE WORLD BUMHAN ● WE MAKE FOR YOU ● TO THE WORLD BUMHAN

Selection Table

Type (형식명)	Specification(사양)			Dimension (외형치수, mm)						Weight (kg)	Remark	Shape	
	Pri.(V)	Sec.(V)	Cap.(VA)	W	D	H	a	b	ØA×B				
BHTB -DQ50TU	440V 415V 400V 380V 0	230V 220V 110V 0 SE	50	79	98	87	65	77	5×8	1.7	Fig. 1		
-DQ100TU			100	90	101	95	72	77		2.3			
-DQ200TU			200	110	115	116	94	87		3.9			
-DQ300TU			300	138	124	139	110	89	5×10	6.7			
-DQ500TU			500	156	158	155	130	104	6×10	10			
-DQ1KTU			1k	185	153	178	160	122	8×20	15.6			
-DQ2KTU			2k	220	179	218	170	139	10×25	24.6		Fig. 2	
-DQ3KTU			3k	258	206	245	195	156		38.4			
-DQ5KTU			5k	280	218	269	220	174		53.6			Eye Bolts
-DQ10KTU			10k	311	290	306	252	240		13×30			96

TO THE WORLD BUMHAN ● WE MAKE FOR YOU ● TO THE WORLD BUMHAN ● WE MAKE FOR YOU ● TO THE WORLD BUMHAN ● WE MAKE FOR YOU ● TO THE WORLD BUMHAN