

TRANSFORMERS

1Ø Double Wind Transformers (단상 복권식 트랜스)

BHTB-DB Series



Technical Specifications

Primary Voltage	210_R220_230V
Secondary Voltage	12_18_R24V
Operating Frequency	50/60Hz
Insulation Class	B Class
Standard	IEC, KS C

Typical Applications

- Control panel
- Semi conductor, Display power equipment
- Machinery
- Heater control
- etc.

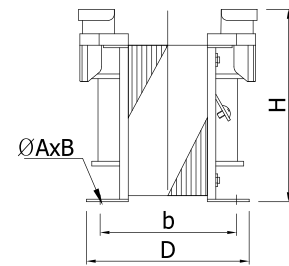
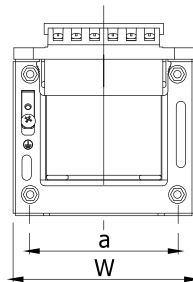
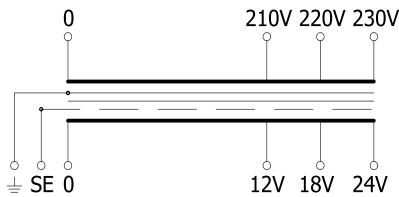

TO THE WORLD BUMHAN ● WE MAKE FOR YOU ● TO THE WORLD BUMHAN ● WE MAKE FOR YOU ● TO THE WORLD BUMHAN ● WE MAKE FOR YOU ● TO THE WORLD BUMHAN

Selection Table

Type (형식명)	Specification(사양)			Dimension (외형치수, mm)						Weight (kg)	Remark	Shape
	Pri.(V)	Sec.(V)	Cap.(VA)	W	D	H	a	b	ØA×B			
BHTB-DB40	230V 220V 210V 0	24V 18V 12V 0 SE	40	79	86	87	65	65	5×8	1.26		
-DB50			50	79	91	87	65	70		1.42		
-DB75			75	90	99	95	72	74		2.14		
-DB100			100	90	101	95	72	77		2.26		
-DB150			150	110	110	116	94	82		3.38		
-DB200			200	110	115	116	94	87		3.88		
-DB300			300	117	116	122	96	88	5×10	4.7		
-DB500			500	138	127	142	110	94		7.03		

TO THE WORLD BUMHAN ● WE MAKE FOR YOU ● TO THE WORLD BUMHAN ● WE MAKE FOR YOU ● TO THE WORLD BUMHAN ● WE MAKE FOR YOU ● TO THE WORLD BUMHAN