

TRANSFORMERS

1Ø Double Wind Transformers (단상 복권식 트랜스)

BHTB-DH Series



Technical Specifications

Primary Voltage	210_R220_230V
Secondary Voltage	0_110(S1) 0_24_26V(S2)
Operating Frequency	50/60Hz
Insulation Class	B Class
Standard	IEC, KS C

Typical Applications

- Control panel
- Semi conductor, Display power equipment
- Machinery
- Heater control
- etc.

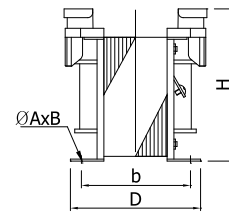
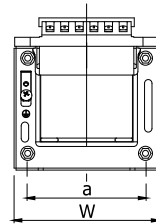
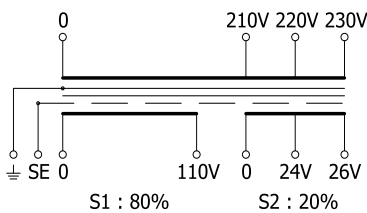

TO THE WORLD BUMHAN ● WE MAKE FOR YOU ● TO THE WORLD BUMHAN ● WE MAKE FOR YOU ● TO THE WORLD BUMHAN ● WE MAKE FOR YOU ● TO THE WORLD BUMHAN

Selection Table

Type (형식명)	Specification(사양)			Dimension (외형치수, mm)						Weight (kg)	Remark	Shape
	Pri.(V)	Sec.(V)	Cap.(VA)	W	D	H	a	b	ØA×B			
BHTB -DH50	230V 220V 210V 0	24V 0	50	79	91	87	65	70	5×8	1.43		
-DH100			100	90	101	95	72	77		2.28		
-DH150			150	116	110	116	94	82		3.35		
-DH200			200	116	115	116	94	87		3.82		
-DH300		300	117	116	122	96	88	5×10	4.65			
-DH500		500	138	129	139	110	94		7.12			
-DH1K		1k	156	167	156	130	113	6×10	11.6			
-DH1.5K		110V 0 SE	1.5k	185	153	178	160	122	8×20	15.8		
-DH2K			2k	185	173	178	160	141		19.8		

TO THE WORLD BUMHAN ● WE MAKE FOR YOU ● TO THE WORLD BUMHAN ● WE MAKE FOR YOU ● TO THE WORLD BUMHAN ● WE MAKE FOR YOU ● TO THE WORLD BUMHAN