

# TRANSFORMERS

## 1Ø Double Wind Transformers (단상 복권식 트랜스)

### BHTB-DO Series

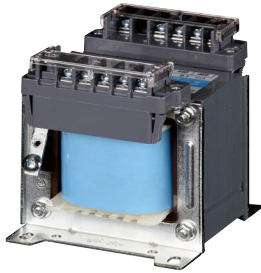

#### Technical Specifications

Primary Voltage	220_R380_420_440_460V
Secondary Voltage	0_110(S1) 0_24_26V(S2)
Operating Frequency	50/60Hz
Insulation Class	B Class
Standard	IEC, KS C

#### Typical Applications

- Control panel
- Semi conductor, Display power equipment
- Machinery
- Heater control
- etc.

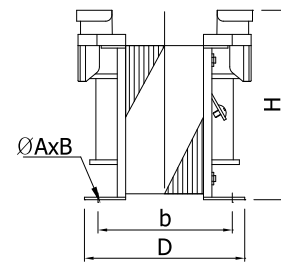
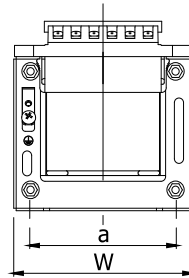
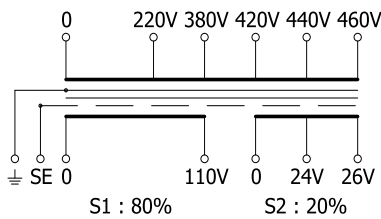

TO THE WORLD BUMHAN • WE MAKE FOR YOU • TO THE WORLD BUMHAN • WE MAKE FOR YOPU • TO THE WORLD BUMHAN • WE MAKE FOR YOU • TO THE WORLD BUMHAN

#### Selection Table

Type (형식명)	Specification(사양)			Dimension (외형치수, mm)						Weight (kg)	Remark	Shape
	Pri.(V)	Sec.(V)	Cap.(VA)	W	D	H	a	b	ØA×B			
BHTB - DO50	460V	24V	50	79	91	87	65	70	5×8	1.44		
- DO100	440V	0	100	90	101	95	72	77		2.24		
- DO200	380V 220V	110V 0	200	116	115	116	94	87		3.8		
- DO300	0	SE	300	117	116	122	96	88	5×10	4.65		
- DO500	460V 440V	26V 24V	500	138	129	139	110	94		7.2		
- DO1K	420V	0	1k	156	167	156	130	113	6×10	11.7		
- DO1,5K	380V 220V	110V 0	1,5k	185	153	178	160	122		8×20	16	
- DO2K	0	SE	2k	185	173	178	160	141	20			

TO THE WORLD BUMHAN • WE MAKE FOR YOU • TO THE WORLD BUMHAN • WE MAKE FOR YOPU • TO THE WORLD BUMHAN • WE MAKE FOR YOU • TO THE WORLD BUMHAN