

3Ø, 250Vac (30/40/50/60A) : 삼상 교류 250V 고감쇠 인버터 출력용
BIR-2*-MS Series (Inverter output filters)**



■ **Features**

- For Inverter output
- High performance
- Multi stage
- Small size
- Low cost
- Dual PE system

■ **Typical Applications**

- AVR, UPS, Inverter, Converter
- Motor drive equipments
- Factory automation equipment
- Three-phase electricity supply
- ACB Panel, distribution Panel

■ **Technical specifications**

Items	BIR-2030-MS	BIR-2040-MS	BIR-2050-MS	BIR-2060-MS
Rated Voltage (V _R)	3Ø, 250Vac			
Operating frequency	50 / 60Hz			
Rated Currents @40°C (I _R)	30A	40A	50A	60A
Withstanding voltage test	Line to Earth : 2,121Vdc for 1min, or 2,750Vdc for 2sec. (BHSTD-QUA-Q201)			
Insulation resistance	500Vdc for 1min. 300MΩ Min. (BHSTD-QUA-Q202)			
Voltage drop	1.0V Max. (BHSTD-QUA-Q204)			
Temperature range	25/100/21 (-25°C to +100°C), 20~95% RH at Operating & Storage			
Designed according to	IEC/EN 60939 / UL1283 / CSA 22.2 No.8			

■ **Derating Curve**

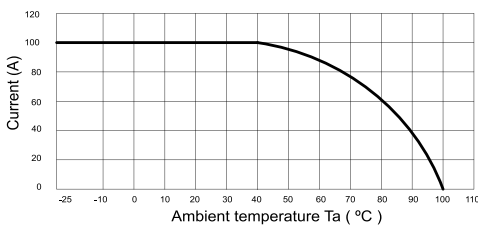

■ **Shape & Dimension (mm)**

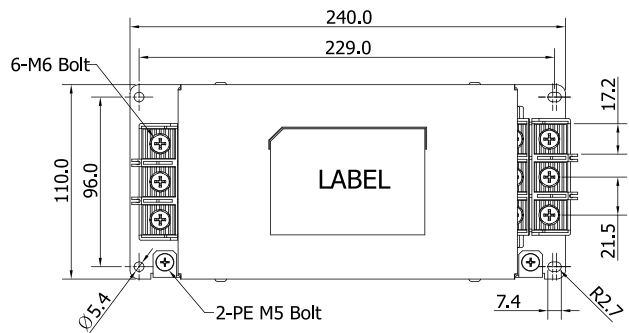

■ **Lug ring terminal**

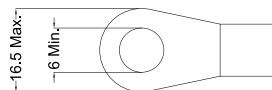

■ **Recommended torque**

4.0 ~4.9 N · m

